



2.5 Laufleisten

Mittelführungen



Laufleisten

drawer slides

Ausfuhrung
type

Beschreibung
description

1

Laufleiste zum Eindubeln

Bohr raster 32 mm
In einigen Modellen befinden
sich zusatzliche Schraublocher
drawer slide for dowelling
dowel spacing 32 mm
Some types have additional
screw holes

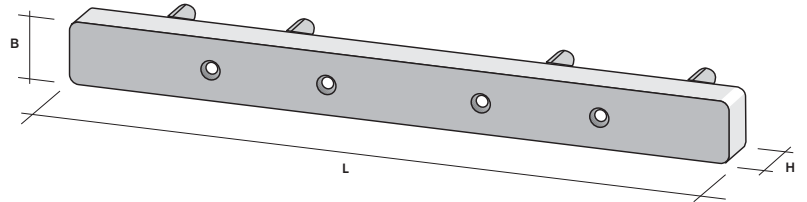

2

Laufleiste zum Anschleen

mit markierten Einschubfeldern
drawer slide for stapling
with marked stapling areas

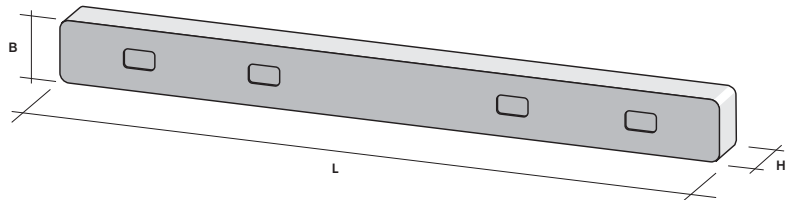

3

Laufleiste zum Anschrauben

Schraublocher 32 mm Bohrraster
drawer slide screwable
spacing 32 mm

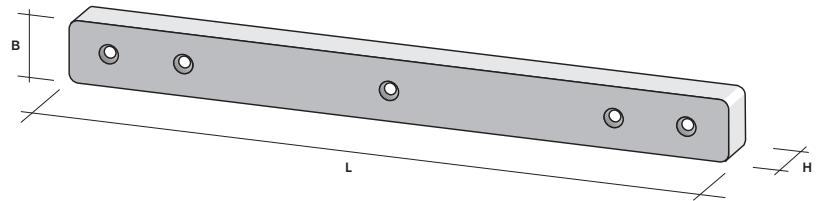

4

Laufleiste zum Eindubeln

Bohr raster 32 mm
In einigen Modellen zusatzlich
Schraubloch/locher.
drawer slide for dowelling
dowel spacing 32 mm
Some types have additional
screw hole(s).

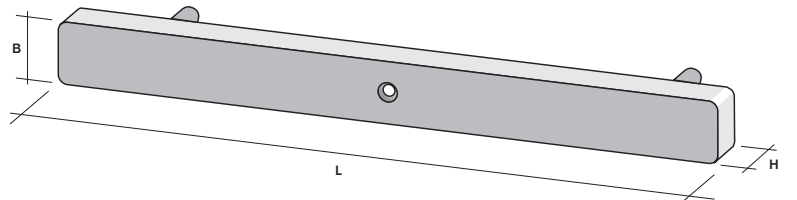

5

Laufleiste

Dubel- oder Lochreihe
drawer slide
dowels or screw holes

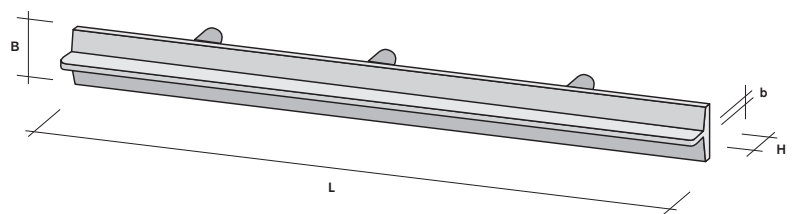

Laufleisten

drawer slides

Ausfuh-
rung
type

Beschreibung
description

6

**Laufleiste zum Dubeln, Schrauben
oder Anschieen**
mit Stopstift, rechte und linke
Ausfuh-
rung
**drawer slide with dowels, screw on
or stapling**
with stop, type right and left

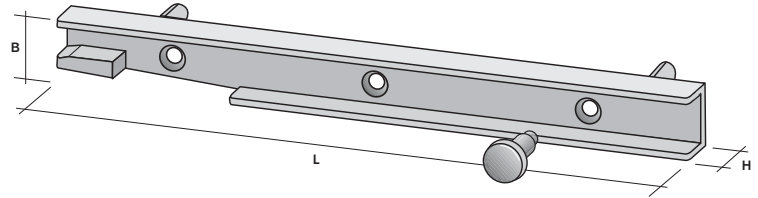

7

**Laufleiste zum Dubeln
und Schrauben**
**drawer slide with dowels
and screw on**

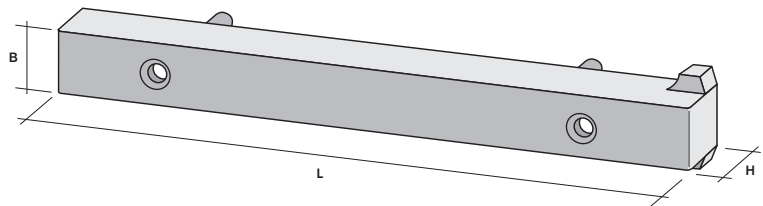

8

**Laufleiste zum Dubeln, Schrauben
oder Anschieen**
mit Stopkante
**drawer slide with dowels, screw on
or stapling**
with stopping edge

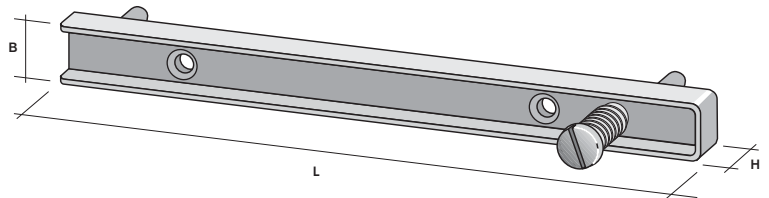

Laufleisten

drawer slides

| Art.-Nr. art.-no. | Verp.-Einh. packing unit | Ausführ. type | Breite B width B | Höhe H height H | Länge L length L | Dübel dowel | Dübelabstand von vorn dowel-spacing from the front | schraubbar screwable | Lochabstand von vorn hole spacing from the front | schießbar for stapling | m. Stoppkante w. stop. edge |
|----------------------|-----------------------------|------------------|---------------------|--------------------|---------------------|----------------|---|-------------------------|---|---------------------------|--------------------------------|
| 31.0840 | 1.000 | 5 | 24/9 | 32,5 | 331 | 2 x ø 5 | 14/288/29 | - | - | - | - |
| 31.1200 | 200 | 5 | 24/9 | 39 | 331 | 2 x ø 5 | 14/288/29 | - | - | ● | - |
| 31.1880 | 900 | 1 | 10 | 10 | 130 | 2 x ø 8 | 17/96/17 | - | - | - | - |
| 31.0880 | 1.500 | 4 | 10 | 11 | 228 | 3 x ø 5 | 18/96/96/18 | - | - | - | - |
| 31.1590 | 450 | 4 | 10 | 17,2 | 299 | 2 x ø 5 | 14/256/29 | - | - | - | - |
| 31.1000 | 2.400 | 8 | 11,8 | 8,2 | 229 | - | - | ● | 14,5/80/112/22,5 | ● | ● |
| 31.1010 | 1.100 | 8 | 12 | 16,2 | 230 | - | - | ● | 15/80/112/23 | ● | ● |
| 31.0130 | 650 | 1 | 15 | 11 | 287 | 4 x ø 8 | 31,5/64/96/64/31,5 | ● | 31,5/64/96/64/31,5 | - | - |
| 31.0110 | 700 | 1 | 15 | 11 | 287 | 4 x ø 8 | 31,5/64/96/64/31,5 | - | - | - | - |
| 31.0850 | 500 | 4 | 15 | 14,5 | 329 | 2 x ø 5 | 28/287/14 | ● | 8,5/64/92,5/164 | - | - |
| 31.0100 | 800 | 1 | 15,5 | 8 | 287 | 4 x ø 8 | 31/64/96/64/32 | ● | 6/25/64/96/64/32 | - | - |
| 31.2150 | 1.250 | 6 | 15,5 | 9,5 | 204 | 2 x ø 4,5 | 28,5/160/15,5 | ● | 7,5/94,5/64/38 | ● | ● |
| 31.0970 | 1.400 | 1 | 16 | 8 | 186 | 3 x ø 5 | 29/64/64/29 | ● | 13/160/13 | - | - |
| 31.1560 | 1.400 | 6 | 16 | 8 | 205 | 2 x ø 5 | 31/128/46 | ● | 61/128/16 | - | ● |
| 31.1600 | 1.000 | 4 | 16 | 8 | 260 | 2 x ø 5 | 31/223/6 | ● | 130/130 | - | - |
| 31.0630 | 950 | 4 | 16 | 8 | 298 | 2 x ø 5 | 37/224/37 | ● | 19/130/130/19 | - | ● |
| 31.2090 | 1.250 | 6 | 16 | 8 | 300 | - | - | ● | 20/64/96/96/24 | ● | ● |
| 31.0790 | 950 | 4 | 16 | 8 | 260 | 3 x ø 5 | 6/96/128/30 | - | - | - | - |
| 31.2040 | 1.150 | 6 | 16 | 9,2 | 300 | - | - | ● | 20/64/96/96/24 | ● | ● |
| 31.2130 | 1.150 | 6 | 16 | 9,2 | 300 | - | - | - | - | ● | ● |
| 31.2480 | 800 | 6 | 16 | 9,2 | 299 | 3 x ø 5 | 20/64/192/24 | ● | 36/64/160/40 | ● | ● |
| 31.0780 | 1.500 | 6 | 16 | 10 | 200 | - | - | ● | 27/78/78/17 | ● | ● |
| 31.0760 | 1.400 | 8 | 16 | 10 | 220 | - | - | ● | 14/18/14/64/82/28 | ● | ● |
| 31.1210 | 1.400 | 8 | 16 | 10 | 220 | - | - | - | - | ● | ● |
| 31.1180 | 900 | 1 | 16 | 10 | 222 | 3 x ø 8 | 15/96/96/15 | ● | 31/160/31 | - | ● |
| 31.1840 | 900 | 8 | 16 | 10 | 222 | 4 x ø 8 | 15/32/64/96/15 | ● | 31/160/31 | - | ● |
| 31.1740 | 850 | 8 | 16 | 10 | 280 | 2 x ø 5 | 28/224/28 | ● | 12/128/128/12 | ● | ● |
| 31.2000 | 1.200 | 8 | 16 | 10 | 280 | - | - | ● | 12/128/128/12 | ● | ● |
| 31.1930 | 800 | 8 | 16 | 10 | 282 | 2 x ø 5 | 30/224/28 | ● | 14/128/128/12 | ● | ● |
| 31.2100 | 1.100 | 6 | 16 | 10 | 300 | - | - | ● | 20/64/96/96/24 | ● | ● |
| 31.0300 | 1.200 | 8 | 16 | 11 | 250 | - | - | - | - | ● | ● |
| 31.2310 | 750 | 8 | 16 | 11 | 400 | - | - | - | - | ● | ● |
| 31.2240 | 900 | 8 | 16 | 12 | 220 | 2 x ø 5 | 27,5/160/32,5 | ● | 15/95/110 | ● | ● |
| 31.1280 | 1.200 | 8 | 16 | 12 | 220 | - | - | ● | - | - | - |
| 31.2060 | 1.000 | 3 | 16 | 12 | 240 | - | - | ● | 15/13/83/77/32 | ● | ● |
| 31.0310 | 1.000 | 2 | 16 | 12 | 250 | - | - | - | 24/96/96/24 | - | - |
| 31.2030 | 800 | 8 | 16 | 12 | 350 | - | - | - | - | - | - |
| 31.2200 | 650 | 8 | 16 | 13 | 274 | 5 x ø 8 | 8/32/32/96/96/10 | - | 20/32/64/64/40 | - | - |
| 31.1780 | 650 | 8 | 16 | 14 | 280 | 2 x ø 5 | 28/224/28 | ● | 12/112/112/12 | - | ● |
| 31.0610 | 450 | 7 | 16 | 15,5 | 268 | 3 x ø 5 | 30/128/96/14 | - | - | - | ● |
| 31.1090 | 450 | 7 | 16 | 15,5 | 268 | 3 x ø 5 | 30/128/96/14 | ● | - | - | ● |
| 31.2210 | 800 | 8 | 16 | 16 | 205 | 2 x ø 5 | 29/160/16 | ● | 38/64/64/39 | - | - |
| 31.1170 | 700 | 8 | 16 | 16 | 222 | 3 x ø 8 | 15/96/96/15 | ● | 38,5/64/64/38,5 | ● | ● |
| 31.1850 | 650 | 8 | 16 | 18 | 222 | 4 x ø 8 | 15/32/64/96/15 | ● | 12/32/66/82/28 | ● | ● |
| 31.1700 | 500 | 8 | 16 | 16 | 299 | 2 x ø 5 | 29/256/14 | ● | 39/64/64/132 | - | ● |
| 31.1910 | 500 | 3 | 16 | 17 | 340 | - | - | ● | 26/128/160/26 | - | - |
| 31.3010 | 500 | 3 | 16 | 17 | 340 | - | - | ● | D5=26/160/128/26, D3,7=37/192/111 | - | - |
| 31.2050 | 600 | 6 | 16 | 18 | 220 | 2 x ø 8 | 42/160/18 | - | - | ● | ● |
| 31.0330 | 600 | 3 | 16 | 19 | 250 | - | - | ● | 13/112/112/13 | ● | - |
| 31.2320 | 500 | 8 | 16 | 20 | 222 | 3 x ø 8 | 15/96/96/15 | ● | 31/160/31 | - | ● |
| 31.2110 | 500 | 8 | 16 | 22 | 222 | 3 x ø 8 | 15/96/96/15 | ● | 31/160/31 | - | ● |
| 31.1800 | 450 | 8 | 26 | 16,8 | 285 | - | - | ● | 30,5/53/146,5/55 | - | ● |

Laufleisten drawer slides

Beschreibung
description

mit Rollen
with rollers

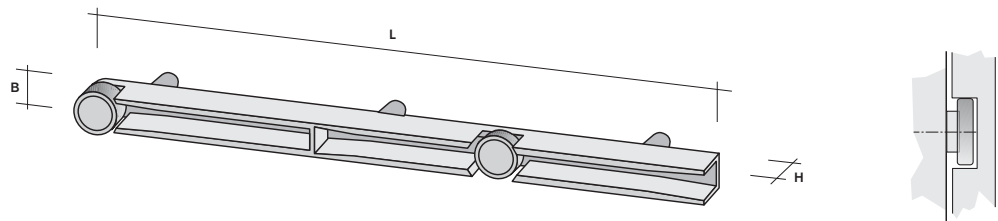

| Art.-Nr. art.-no. | Verp.-Einh. packing unit | Ausführ. type | Breite B width B | Höhe H height H | Länge L length L | Dübel dowel | Dübelabstand von vorn dowel-spacing from the front | schraubbar screwable | Lochabstand von vorn hole spacing from the front | schießbar for stapling | m. Stoppkante w. stop. edge |
|----------------------|-----------------------------|------------------|---------------------|--------------------|---------------------|----------------|---|-------------------------|---|---------------------------|--------------------------------|
| 31.1120 | 400 | 1 | 13 | 10 | 238 | 3 x ø 6 | 10/96/96/36 | ● | 48/44/74/58,5/13,5 | ● | ● |
| 31.1940 | 500 | 2 | 16 | 10 | 233,5 | 3 x ø 8 | 24/64/128/17,5 | ● | 33,5/96/96/8 | - | ● |
| 31.2010 | 1.100 | 2 | 16 | 12 | 233,5 | - | - | ● | 33,5/96/96/8 | ● | ● |
| 31.2070 | 350 | 2 | 16 | 12 | 350,5 | - | - | ● | 33,5/96/96/96/29 | ● | ● |
| 31.2890 | 250 | 2 | 16 | 12 | 350,5 | 4 x ø 8 | 21/96/96/96/41 | ● | 33,5/96/96/96/29 | ● | ● |

für Drahtkörbe
for wire baskets

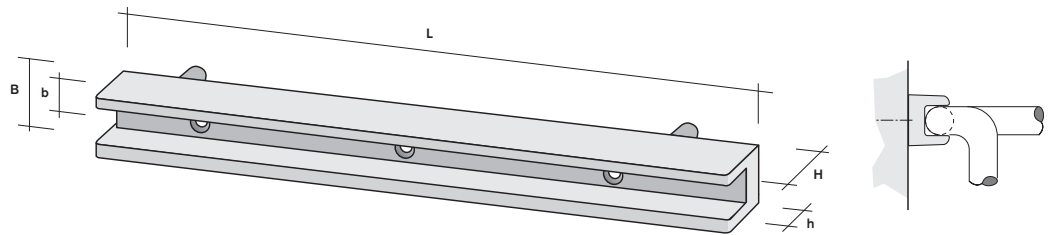

| Art.-Nr. art.-no. | Verp.-Einh. packing unit | Breite B width B | Höhe H height H | Länge L length L | Breite innen b width ins. b | Höhe innen h height ins. h | Dübel dowel | Dübelabstand von vorn dowel-spacing from the front | schraubbar screwable | Lochabstand von vorn hole spacing from the front |
|----------------------|-----------------------------|---------------------|--------------------|---------------------|--------------------------------|-------------------------------|----------------|---|-------------------------|---|
| 31.2580 | 400 | 13 | 23 | 400 | 7 | 11 | - | - | 3 Euro | 22/160/192/26 |
| 31.1650 | 300 | 14,5 | 12,5 | 512 | 8 | 6 | 2 x ø 5 | 28/480/4 | 3 | - |
| 31.0920 | 350 | 13 | 23 | 435 | 6,5 | 11 | - | - | 3 Euro | 26/192/192/25 |
| 31.2290 | 190 | 27,5 | 27 | 495 | 5 | 10 | - | - | 15 | 25/14 x 32/22 |
| 31.1640 | 100 | 32 | 8,5 | 512 | 7,5 | 15 | 2 x ø 5 | 28/480/4 | 3 | 60,5/208/208/35,5 |

mit Aussparung und Anschraubflächen
with cut-out and bolting surface

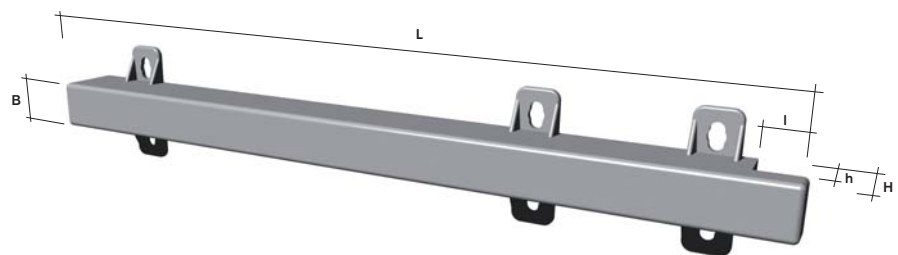

| Art.-Nr. art.-no. | Verp.-Einh. packing unit | Breite B width B | Höhe H height H | Länge L length L | Höhe h height h | Länge l length l | schraubbar screwable | Lochabstand L-Richtung hole spacing L-direction | Lochabstand B-Richtung hole spacing B-direction | schießbar for stapling | m. Stoppkante w. stop. edge |
|----------------------|-----------------------------|---------------------|--------------------|---------------------|--------------------|---------------------|-------------------------|--|--|---------------------------|--------------------------------|
| 31.3020 | 400 | 20 | 25 | 315 | 15 | 17 | ● | 28/192/64/31 | 32 | ● | - |

Stoppstifte für Laufleisten

stops for drawer slides

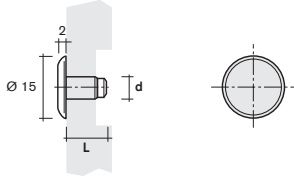
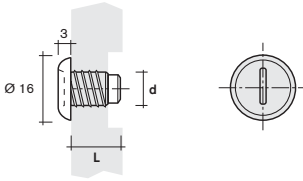
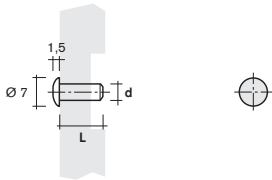
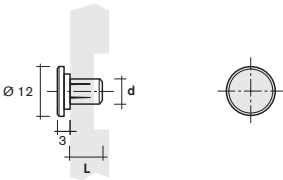
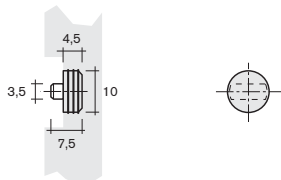
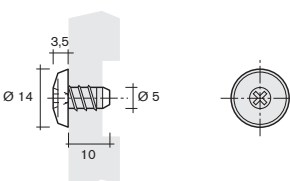
| Art.-Nr. art.-no. | Verp. Einheit packing units | Ausführung type | Farben: Standard colours: standard | |
|----------------------|--------------------------------|--------------------|---------------------------------------|---|
| | | | | gesteckt plugged |
| | | ø d | L | |
| 49.0020 | 5.000 | 5,2 mm | 8 mm |  |
| 49.0010 | 5.000 | 5,2 mm | 10 mm | |
| 49.0030 | 5.000 | 5,2 mm | 12 mm | |
| | | | | 49.0020 |
| | | | | eindrehbar, mit Schlitz screwable, with slot |
| 49.0500 | 3.000 | 8 mm | 10 mm |  |
| 49.0520 | 3.000 | 8 mm | 11,5 mm | |
| 49.0510 | 3.000 | 8 mm | 12 mm | |
| 49.0530 | 3.000 | 8 mm | 13,5 mm | |
| | | | | 49.0510 |
| | | | | gesteckt plugged |
| 49.0070 | 5.000 | 4 mm | 10,5 mm |  |
| 49.0490 | 5.000 | 4 mm | 12 mm | |
| | | | | 49.0070 |
| | | | | gesteckt plugged |
| 49.0080 | 5.000 | 6 mm | 9,5 mm |  |
| 49.0040 | 5.000 | 6 mm | 12,8 mm | |
| | | | | 49.0080 |
| | | | | gesteckt plugged |
| 49.0060 | 4.000 | 10 mm | 4,5 mm |  |
| | | | | 49.0060 |
| | | | | eindrehbar, mit Kreuzschlitz screwable, with slot |
| 49.0480 | 5.000 | 5 mm | 10 mm |  |

Mittelführungen

centre drawer slides

Art.-Nr. Verp. Einheit Ausführung Farben: weiß, braun
 art.-no. packing units type colours: white, brown

31.3030

500 **Winkelaufleiste schraubbar**
 Teilung 288 mm
angle drawer slide, screwable
 spacing 288 mm

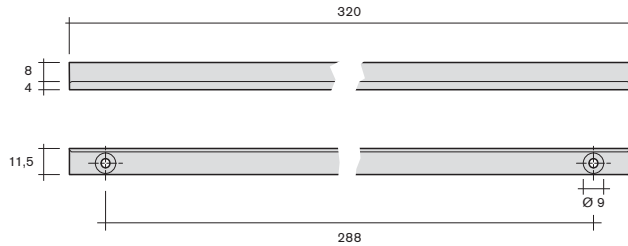

31.1520

500 **schraubbar**
 Teilung 96 mm
screwable
 spacing 96 mm

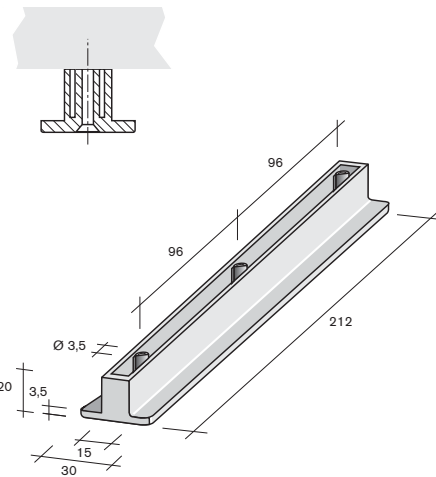

31.1020

85 **4-fach gedübelt**
 260 x 62 x 48 mm
 Dübel ø 6 mm
 Teilung 32/160/32
4-times dowelled
 260 x 62 x 48 mm
 dowel ø 6 mm
 spacing 32/160/32

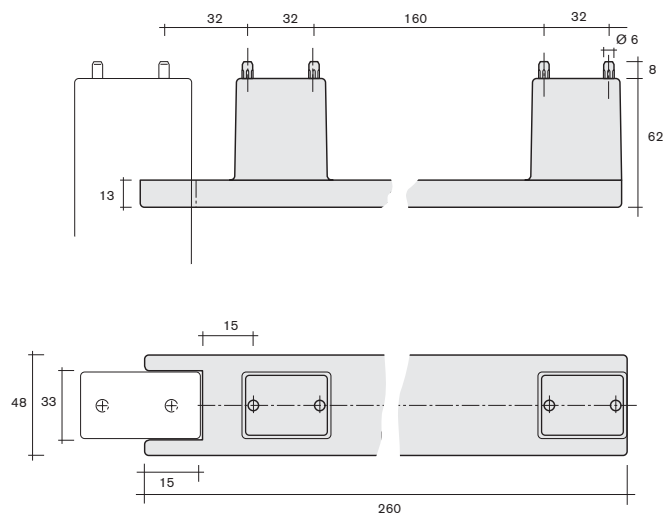

Mittelführungen

centre drawer slides

Art.-Nr. Verp. Einheit Ausfuhrung Farben: Standard
 art.-no. packing units type colours: standard

31.1950

75

3-fach gedubelt
 310 x 49 x 51,7 mm
 Dubel \varnothing 8 mm
 Teilung 224/32 mm
3-times dowelled
 310 x 49 x 51.7 mm
 dowel \varnothing 8 mm
 spacing 224/32 mm

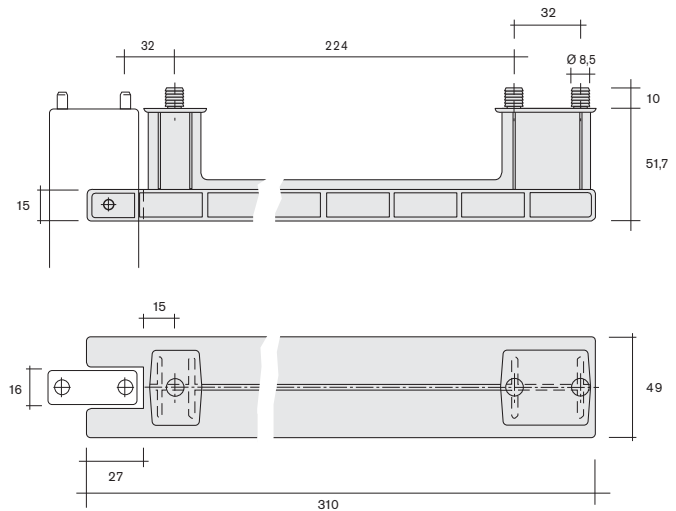

31.2570

600

**zur Anbringung zwischen
 Pfosten und Traverse**
*for fixing between
 shaft and crosspiece*

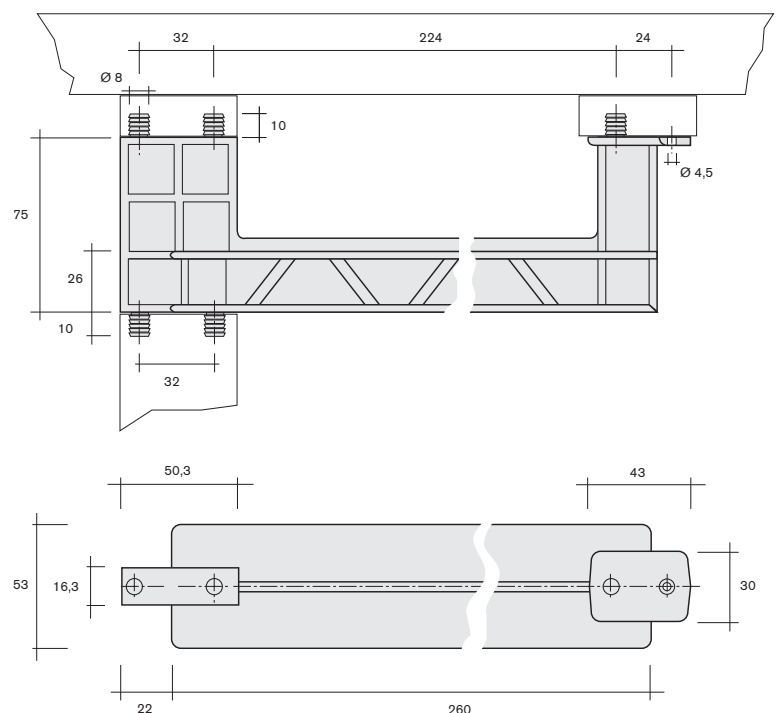

Mittelführungen

centre drawer slides

Art.-Nr. Verp. Einheit Ausführung Farben: weiß, braun
 art.-no. packing units type colours: white, brown

31.2600

400 **Mittelführung für BLUM-Führung**
centre drawer slide for BLUM guide

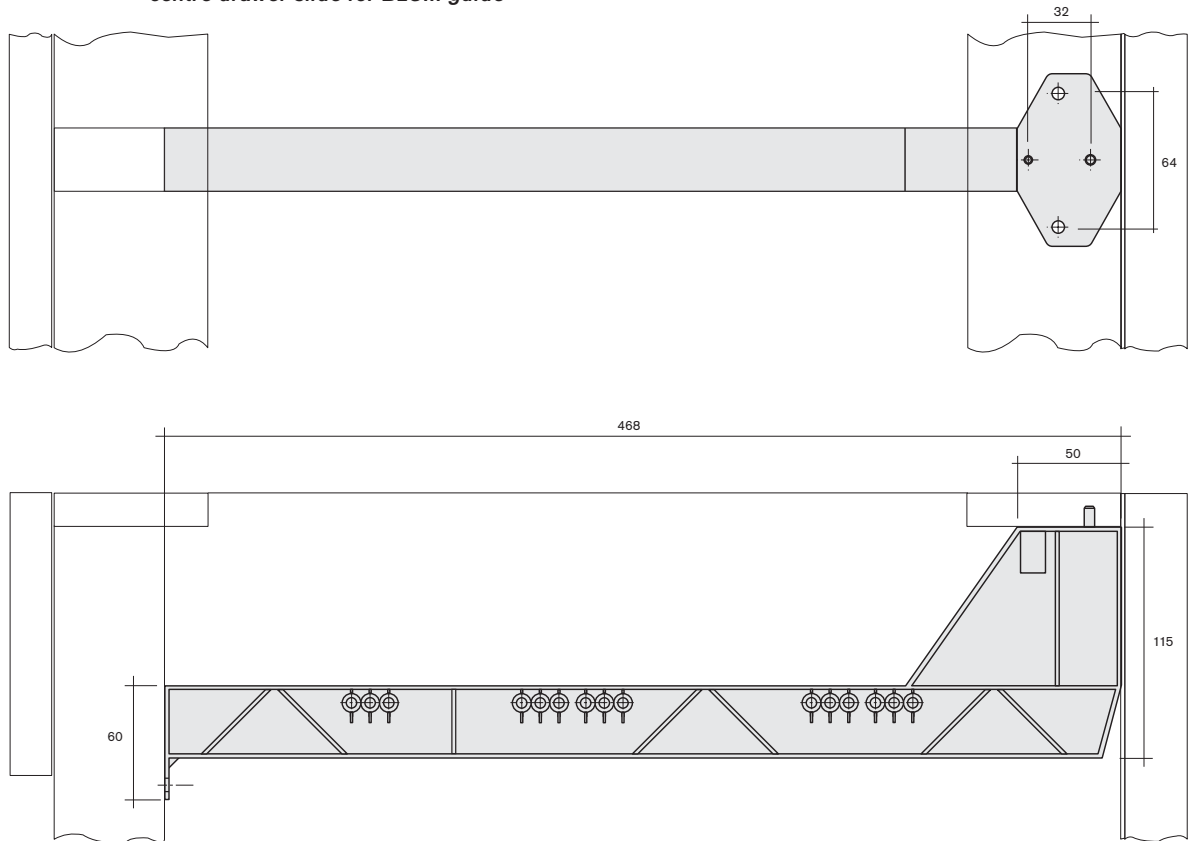

31.2950

400 **Mittelführung für Kugelauszüge**
centre drawer slide for ball excerpts

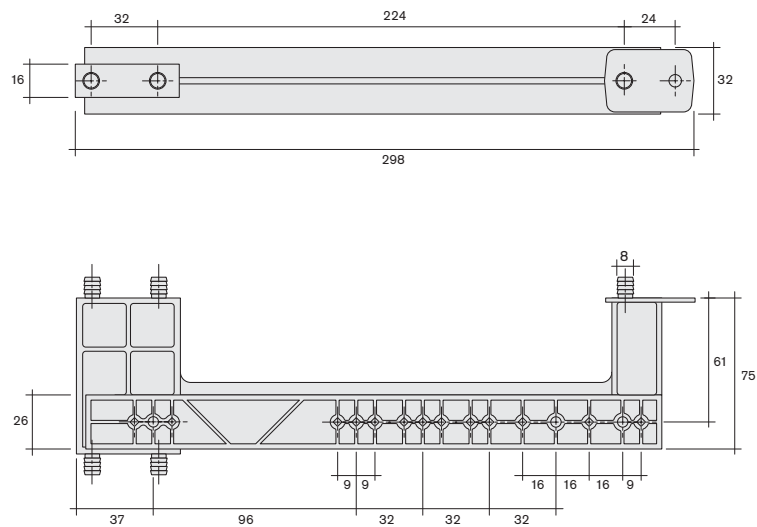

Mittelführungen

centre drawer slides

Art.-Nr. Verp. Einheit Ausfuhrung Farben: Standard
art.-no. packing units type colours: standard

31.3050

1000

Mittelfuhrung fur Schubkasten-Schienen-Aufnahme
centre slide for drawer rail admission

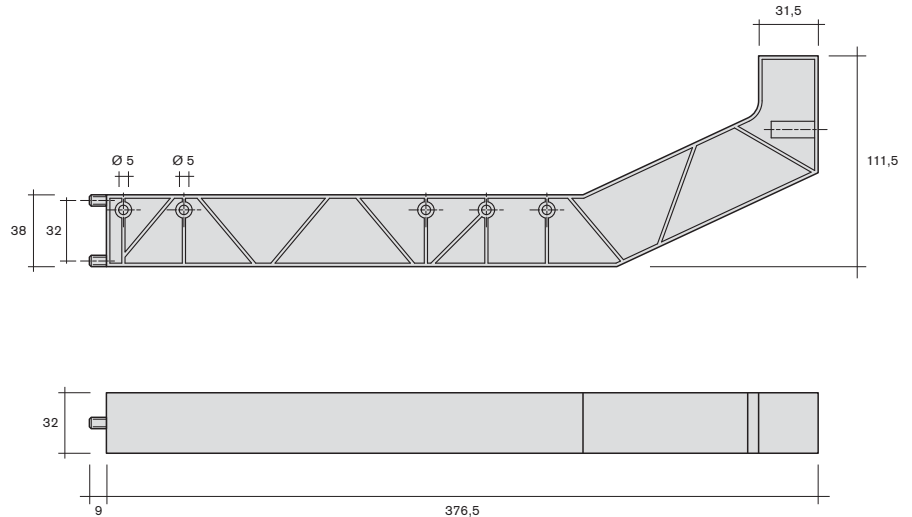

31.3040

900

Mittelfuhrung fur Schubkasten-Schienen-Aufnahme
centre slide for drawer rail admission

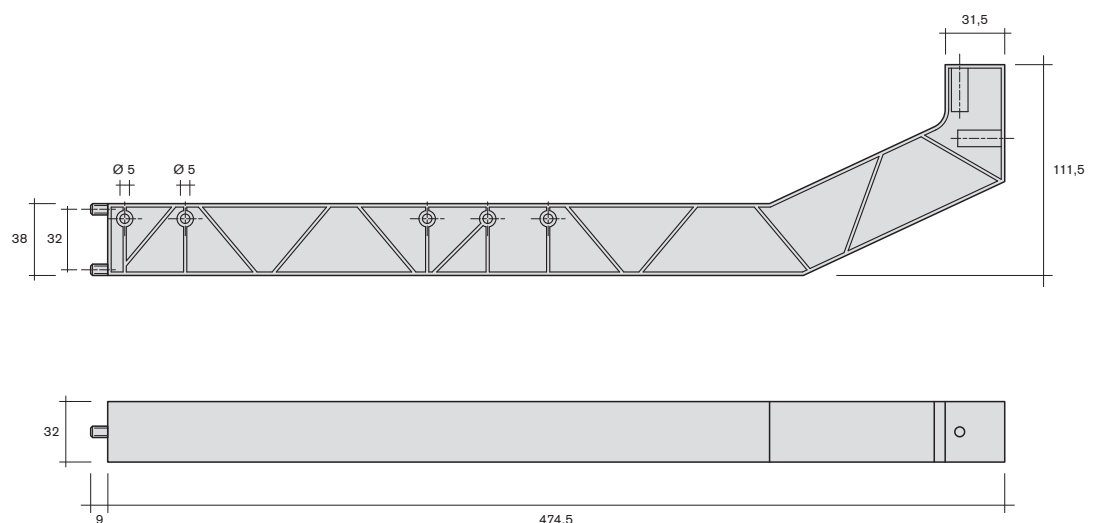

Mittelführungen

centre drawer slides



| Art.-Nr. <i>art.-no.</i> | Verp. Einheit <i>packing units</i> | Ausfuhrung <i>type</i> | Farben: Standard <i>colours: standard</i> |
|-----------------------------|---------------------------------------|----------------------------|--|
|-----------------------------|---------------------------------------|----------------------------|--|

